

OVERO

CDF

Compact Density Fiberboard

Waterproof
Compact Flooring



8 mm thickness.

DISCOVER COMFORTABLE LIVING, REDEFINE YOUR LIFESTYLE.

What is CDF?

Compact Density Fiberboard

Compact Density Fibreboard (CDF) flooring is a type of engineered wood flooring that is made from compact density fiberboard.

CDF is a high-quality composite material made from wood fibers, resin, and wax, which are compressed under high pressure to create a dense and durable flooring product.

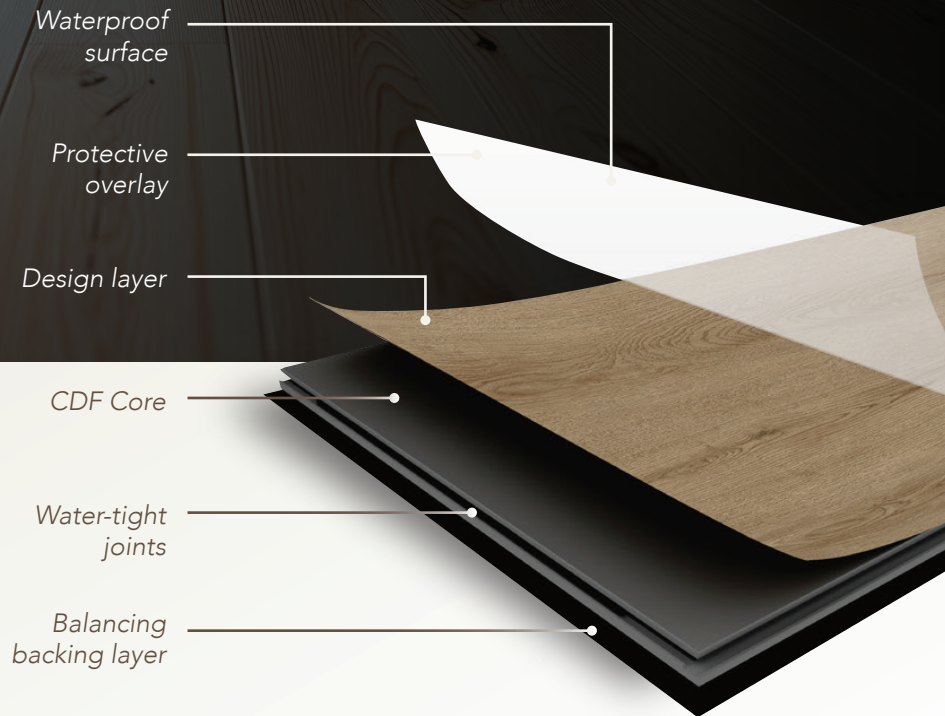

SLIP RESISTANT



WATERPROOF



STAINPROOF



DENTPROOF



STYLISH



SCRATCH-RESISTANT



FIRE-RESISTANT



SIMPLICLEAN



GEOHERMAL

Waterproof Compact Flooring

PVC FREE, WATERPROOF & FIRE-RESISTANT



High Performance Waterproof.



4 Edges

Bevel Design.



The rounded bevel provides an authentic wood look.

EASY & LAST LONGER

Click System.

Waxing Waterproof Click

Waterproof click system flooring featuring an added layer of wax protection.

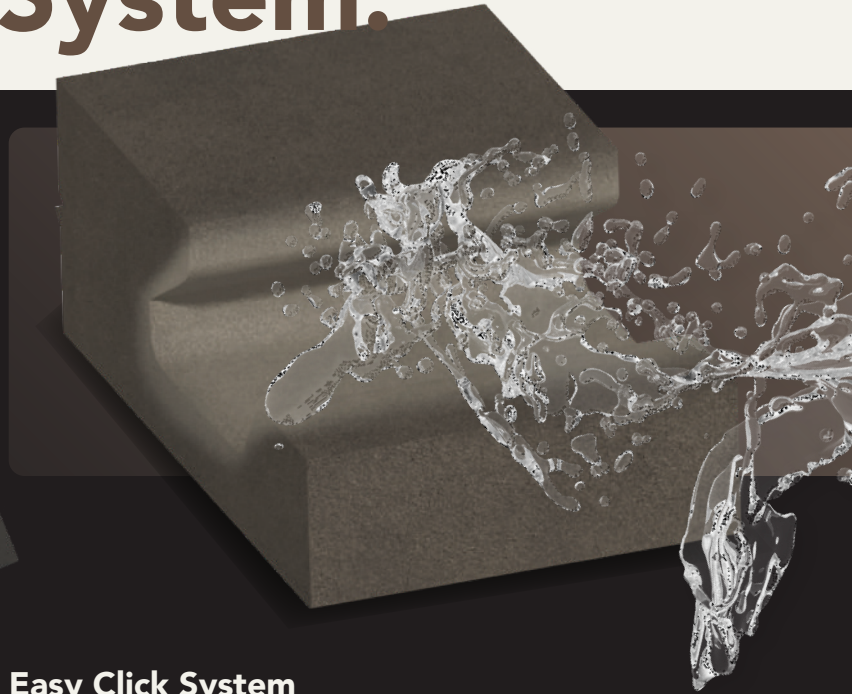
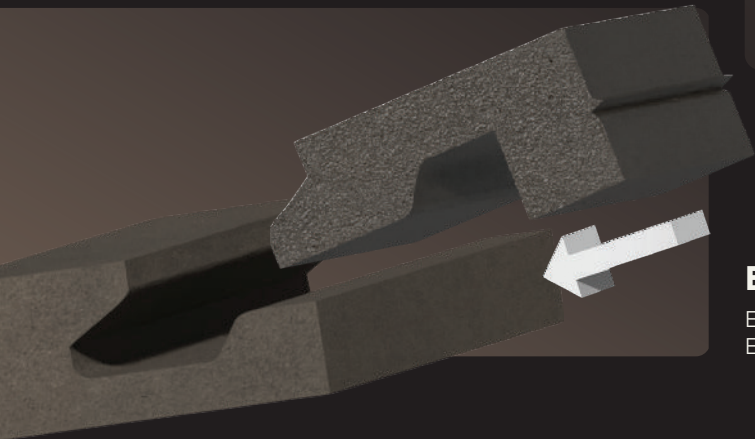

Easy Click System

Experience the Ultimate in Flooring Convenience with Our Easy Click System. Effortless Installation, Stunning Results.



Aluminum Oxide Finishing

Stain Resistant

Aluminum oxide finishing not only adds remarkable durability to flooring but also enhances its stain resistance, ensuring long-lasting beauty and protection.

Scratch Resistant

Resisting scratches, gouges, and pits, ideal for those tough on their floors.

You will no longer have to worry about little ones dropping heavy objects, scratches from dog or cat claws.



Color Options

If you want flooring that looks just like real wood, we have fantastic options for you! Our products come in smooth surfaces and sophisticated textures, which are almost impossible to tell apart from genuine wood.



OR8001
Endless



OR8002
Letsch



OR8003
Light Moon



OR8004
Cloud



OR8005
Maryland

More Color options coming soon

INSTALL OUTCOME

1215mm (L) x 196mm (W) x 8mm (T) | 1 box = 10 panels (25.62sqft)

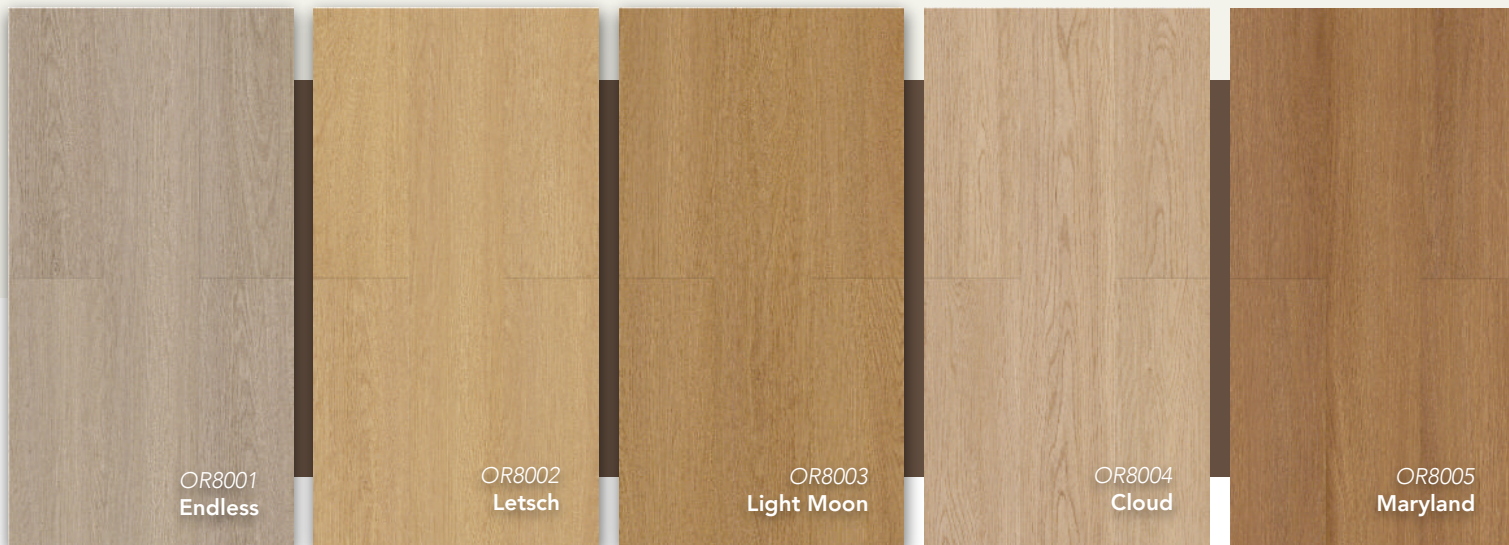

8mm thickness.

More Color options coming soon



OR8001
Endless





OR8002
Letsch





OR8003
Light Moon





OR8004
Cloud





OR8005
Maryland

Mouldings & Skirting



Underlayment



P.E Underlay

- Thickness: 2mm
- To Compensate the uneven of the subfloor that $\leq 3\text{mm}$ per 1m^2 area.
- To absorb noise from the contact of flooring panel with the subfloor.

Plastic Sheet

- Thickness: 0.1mm
- To act as a moisture barrier from the subfloor to the flooring panels.



IXPE Underlay

- Thickness: 1.5 mm
- IXPE is a high-performance sound-dampening underlayment with moisture-protective film joints.protection at its joints. Suitable for
- Home Theatre and equivalent

Plastic Sheet

- Thickness: 0.1mm
- To act as a moisture barrier from the subfloor to the flooring panels.

PVC Profile

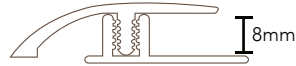
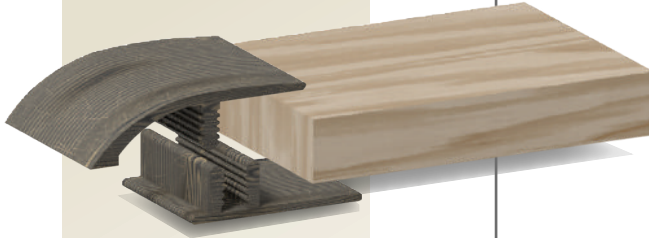

8mm Adaptation

(PVC-A: 14mm(H) x 55mm (W) x 2700mm)

Connect between different levels of adjoining floors or surfaces.



More Color options coming soon.

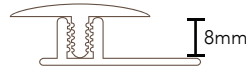
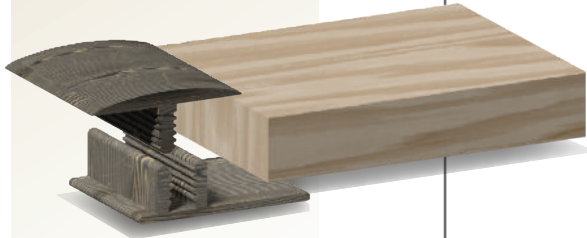

8mm Transition

(PVC-T: 12mm(H) x 42mm(W) x 2700mm)

Connect between same levels of adjoining floors or surfaces.



More Color options coming soon.

PVC Profile

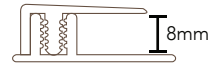
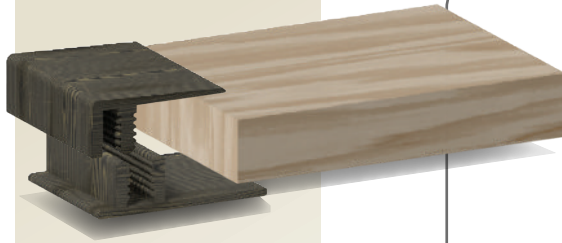

8mm End

(PVC-E: 10mm(H) x 28mm(W) x 1215mm)

Flooring edge protector and finisher.



More Color options coming soon.

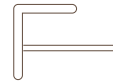

8mm Nosing

(PVC-N: 26mm(H) x 34mm(W) x 1215mm)

Stair edge that extends for safety and surface area.



More Color options coming soon.

PVC Profile



70mm Skirting

(PVC-S: 70mm(H) x 15mm(W))

Protective trim at the base of walls.



More Color options coming soon.



100mm Skirting

(PVC-S: 100mm(H) x 15mm(W))

Protective trim at the base of walls.



More Color options coming soon.

Technical Features

Waterproof Compact Flooring



Compact Density Fibreboard vs High Density Fibreboard

- CDF flooring is denser and more durable than HDF flooring.
- CDF has better moisture resistance than HDF.
- Both CDF and HDF come with easy click-lock or tongue-and-groove installation.
- Choose CDF for maximum durability, or HDF for a more budget-friendly option.

Item	CDF	HDF
Density	$\geq 900 \text{ kgs/m}^3$	$800\text{-}850\text{kgs/m}^3$
Thickness Range	8mm	8-15mm
Water Swelling	<3.6%	<18%
Formaldehyde Emission	CARB P2	E1 / CARB P2
Reaction to Fire	Bs1-d0	Cfl-s1
Flatness	$\pm 0.2\text{mm}$	$\pm 0.5\text{mm}$
Internal Bond Strength	$>3.0\text{N/mm}^2$	$>1.0\text{N/mm}^2$
Flexural Strength	$>6000\text{N/mm}^2$	$>3500\text{N/mm}^2$



Waterproof performance









CDF is proud of its moisture-proof quality and our watertight click system and high polymer waterproof sealer on while edge make waterproof to resist any life spills and wet cleanings like steam mopping.



Install over 3,200ft/ 300m² without transitions

It can handle high heat and temperature changes really well, so you can put it in big spaces without needing to break it up with transitions.

CERTIFICATIONS & TEST RESULTS

Characteristics		Result
	Reaction to Fire	Bs1-d0
	Thickness Swell	Mean 3.6%
	Dimensional Stability-humidity	Passes (<0.35%)
	Dimensional Stability-Temp	Passes ($\leq 0.30\%$)
	Classification(Level of Use)	Passes (Class33)
	Resistance to Staining	Passes
	Castor Chair Resistance	No disturbance to the surface; No delamination, Cracks or visible damages
	Locking Strength	Passes ($\geq 1.0\text{kN/M}$)
	Slip Resistance AMD Dry Condition AMD Wet Condition	Coefficient: .59(Static); .42(Slide) Coefficient: .59(Static); .46(Slide)
	ORTHO-PHALATES	N/A
	LEAD/METALS	N/A
	BENZEN/XYLENE	N/A
	TRIBUTYL TIN	N/A
	PCP (PENDACHLOROPHENOL)	N/A
	CE Certification	Passes
	EPA(Core)	Passes
	VOC	Passes

PVC FREE, WATERPROOF & FIRE-RESISTANT

Brochure CDF
2023



Compact Density Fiberboard

Reach us for more details.